

1



SUPPORT PATIENT'S HEAD

- Place a pillow or rolled towel behind the patient's neck to reduce pressure on electrode 5 and 10 if patient is lying

2



PULL HAIR BACK

- Remove glasses and hair accessories
- Tuck hair behind ears

3

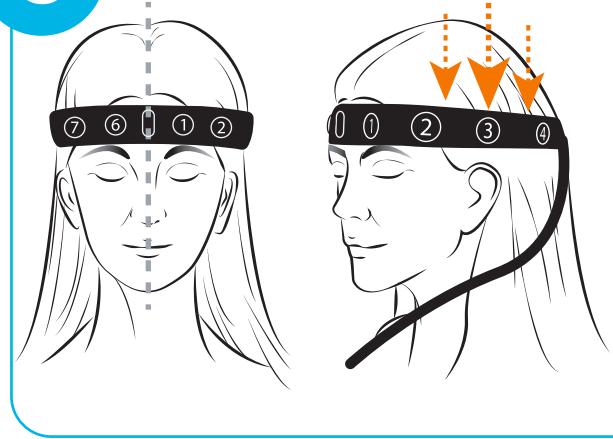

PLACE HEADBAND

- Close clasp centered on forehead, with cable oriented downwards
- Slide down to just above ears

4

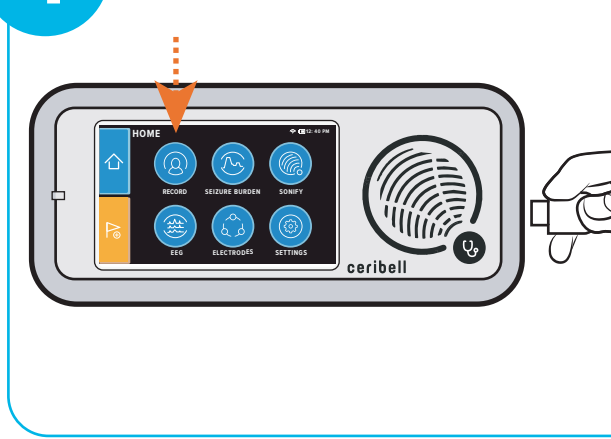

PLUG INTO DEVICE

- Plug headband cable into EEG device
- Go to the RECORD page, enter patient information, and proceed to the ELECTRODE page

ADDITIONAL INFORMATION, PRECAUTIONS, AND WARNINGS

24 Hour Customer Support: 1-800-763-0183

Small Size
Head Circumference:
45.1 to 54.5 cm



Use outside of the prescribed head circumference range will significantly negatively impact device effectiveness and the reliability of the resulting data, which may lead to misdiagnosis.



MR Unsafe. Remove headband from patient prior to performing Magnetic Resonance Imaging (MRI).



If skin irritation is noted, stop use and remove headband.



Only connect the headband to the Ceribell EEG Device.

Indications for Use:

The Ceribell EEG Headband is an electroencephalogram (EEG) electrode array intended for single patient use in the recording of EEGs. The EEG Headband is intended for prescription use in the home, healthcare facility, or clinical research environment.

5

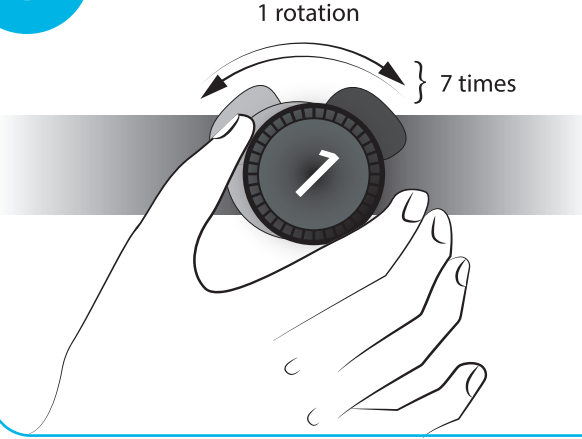

PREPARE ELECTRODE 1

- Rotate ELECTRODE 1 back and forth to complete a full rotation
- Repeat for 5 rotations

6

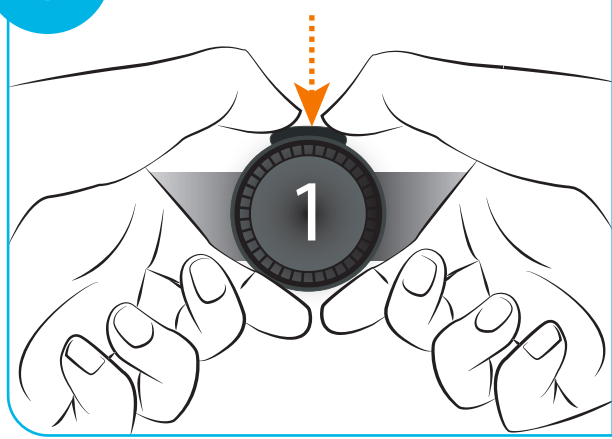

DISPENSE GEL

- Return electrode to upright position
- Squeeze plunger firmly to dispense gel
- Repeat Step 5 and 6 on other electrodes

7

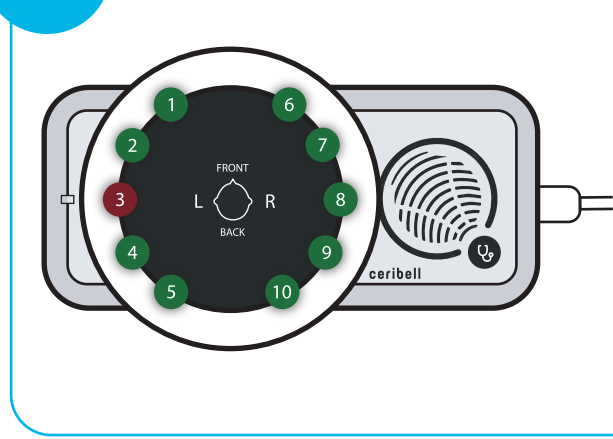

CHECK DEVICE

- Electrode(s) with poor signal will appear red and must be fixed

8

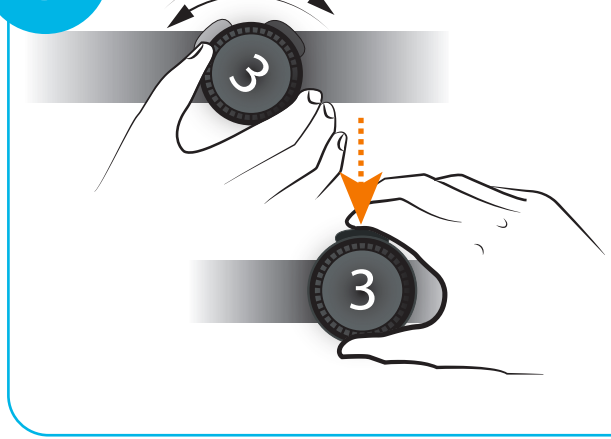

FIX ELECTRODES

- To fix electrodes, repeat rotations then squeeze plunger to dispense more gel
- Repeat as needed until all electrodes on device appear green