

Additional Gel Guide

If an electrode connection needs to be improved on the EEG Headband, more conductive gel can also be added by following the steps below:

Scan for training



1

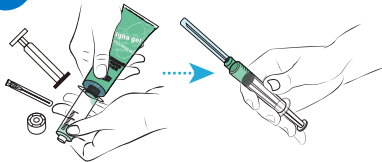

REMOVE PLUNGER & REPLACE PLUNGER

Remove the plunger from the syringe. Then add approximately 5 ml of gel into the syringe.

Replace the plunger back into the syringe. Remove any excess air and attach blunt tip needle.

2

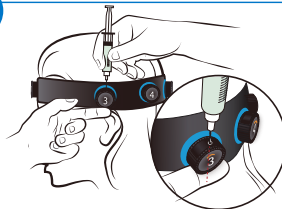

INSERT SYRINGE

Support electrode and insert syringe fully into gel filling port on the top of the plunger.

3

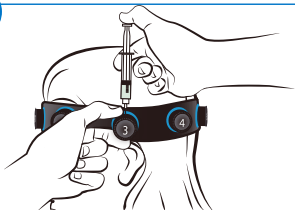

ADD GEL

Hold down plunger and administer approximately 1 ml of gel.

4

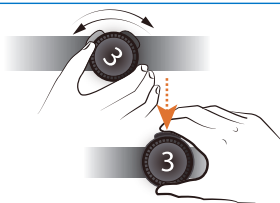

FIX ELECTRODES

To fix electrodes, repeat rotations then squeeze plunger to dispense more gel.

Repeat as needed until all electrodes on device appear green.

- If needed, additional gel can also be directly added between the patient's scalp and the electrode.
- For 24 hour technical support, additional gel, needles or syringes call: 1-800-763-0183
- Check expiration dates of gel and syringe before use.

- Dispose of sharps into an approved sharps collector in accordance with federal, state, regional, local and/or hospital rules and regulations